

GORDON

COMMERCIAL REAL ESTATE BROKERAGE

FOR LEASE :: 2901 COLLEGE AVENUE, BERKELEY, CA

Prime Corner Retail Space in the Historic Elmwood Shopping District



CONTACT: LORI ROSENTHAL • 510 524-2344 • lori@gordoncommercial.com • DRE#01946676

RARE CORNER RETAIL SPACE WITH ±100' STREET FRONTAGE AND HIGH DAILY TRAFFIC

SIZE: ±2,314 rsf Ground Floor
plus ±1,780 rsf Bonus Basement

ASKING RENT:
\$3.75 psf/month NNN

ZONED: C-E
(Elmwood Commercial District)



- Corner retail space with architectural detail, and nice window line
- Home for many years to the very successful Sweet Dreams
- Welcoming double-door entry with arched window panels, and unique stained glass detail above
- Hardwood floors, and bright natural light
- Excellent signage opportunity
- Across from Baker & Commons, and Mrs. Dalloway's bookstore
- Amid clothing and shoe stores, gift shops, cafés, boutiques, independent merchants and services
- Easy street parking
- Close to corner of Ashby Avenue (CA State Route 13)
- A two-block shopping and dining-centric area and Berkeley's oldest commercial district
- Join Bluemercury luxury beauty, Humphry Slocombe ice cream, Donato & Co, Palm & Perkins home goods, Donato & Co., Nabolom Bakery Pizzeria, Elements boutique, Labels Luxury Consignment, Personal Pizazz fashion, and Cafenated Coffee
- Near UC Berkeley, Alta Bates Hospital, Claremont Hotel & Spa, and Julia Morgan Theatre
- Easy access to the entire SF Bay area via AC Transit, as well as Berkeley and Rockridge BART
- High income, upscale neighborhood



Daily
Traffic Count
25,120



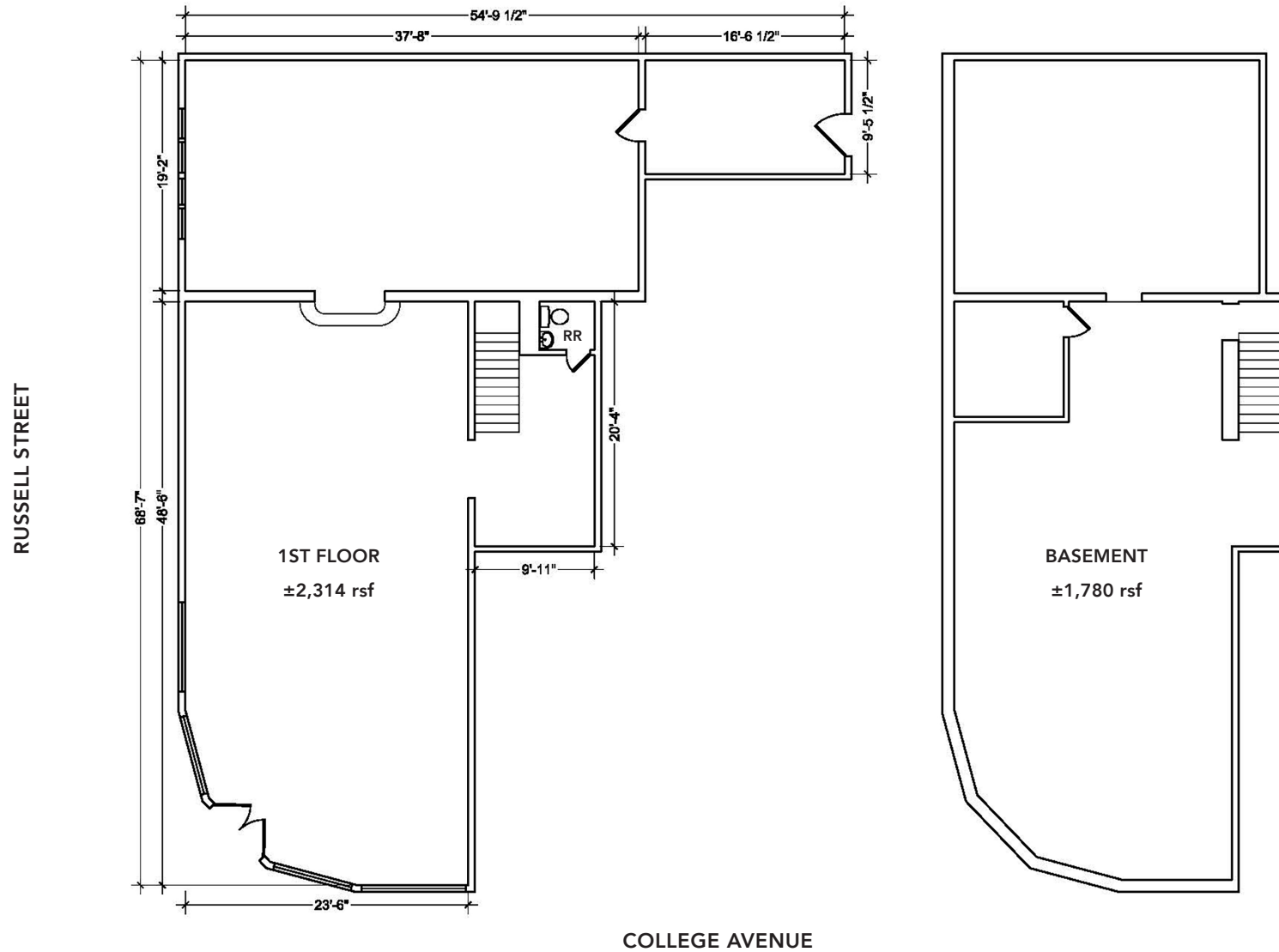

These drawings are intended to be used as an aid for planning. Though care was taken in drawing this elevation and floor plan, accuracy is not guaranteed.



- On College Avenue, you will find a special shopping experience featuring fine gourmet food, outdoor cafes, and shops featuring unique clothing, jewelry, gift items, and quality personal services from local merchants
- Over 80 independently-owned boutiques and restaurants – all within a few blocks
- High-traffic location with convenient freeway access and easy street parking
- .3 mile to Alta Bates Summit Medical Center
- .9 mile to Rockridge BART and 1 mile to Ashby BART
- 1 mile to UC Berkeley campus
- 1.5 miles to Downtown Berkeley
- The Elmwood’s surrounding neighborhood is diverse and densely populated, with high income and education levels, serving a more affluent clientele while also attracting UC Berkeley students and local shoppers.
- Berkeley boasts strong demographics with more affluent households, a higher number of college-educated residents, and much greater spending power than comparable markets

DEMOGRAPHICS	2 MILE	5 MILE
Population	132,482	433,211
Households	55,207	187,385
Average Age	34	38
Average HH Income	\$129,975	\$131,686
Daytime Employees	98,598	278,718

Source: CoStar/Loopnet

GORDON

COMMERCIAL REAL ESTATE BROKERAGE

2901 COLLEGE AVENUE, BERKELEY, CA
NEIGHBORHOOD



The information contained herein has been provided by the owner of the property or other sources we deem reliable. We have no reason to doubt its accuracy, but we cannot guarantee it. All information should be verified prior to leasing.