

FOR LEASE: CENTRALLY LOCATED MANUFACTURING/STORAGE

:: 459 HESTER STREET, SAN LEANDRO, CA ::

**EAST BAY
LOCATION
NEAR I-880
& AIRPORT**



CONTACT: JONATHAN NEWMAN

510 898-2122 • jnewman@gordoncommercial.com • DRE#02118083

GREAT FOR A CONTRACTOR'S STORAGE SPACE. INCLUDES YARD + DEDICATED PARKING

UNITS 5 + 6 (Leased together)

SIZE: ±6,330 RSF

LEASE RATE:

\$7,000/Month IG

Includes a large outdoor covered yard + parking

ZONED: SA-2

- Heavy power and compressed air
- Mezzanine space – which is a bonus (not included in the RSF)
- Large outdoor covered yard
- Majority of building is sprinklered
- Secure space
- Easy freeway access

• Two separate units leased together:

UNIT #6 | ±2,650 RSF

2 roll-up doors. ±7,729 SF outdoor yard with covered area
Dedicated parking

UNIT #5 | ±3,680 RSF with mezzanine space and office

One roll up door facing parking lot
Dedicated parking spaces



While there is no current bathroom, owner is willing to negotiate with tenant to provide TI incentive to have one constructed for a long-term lease at market rents once completed.





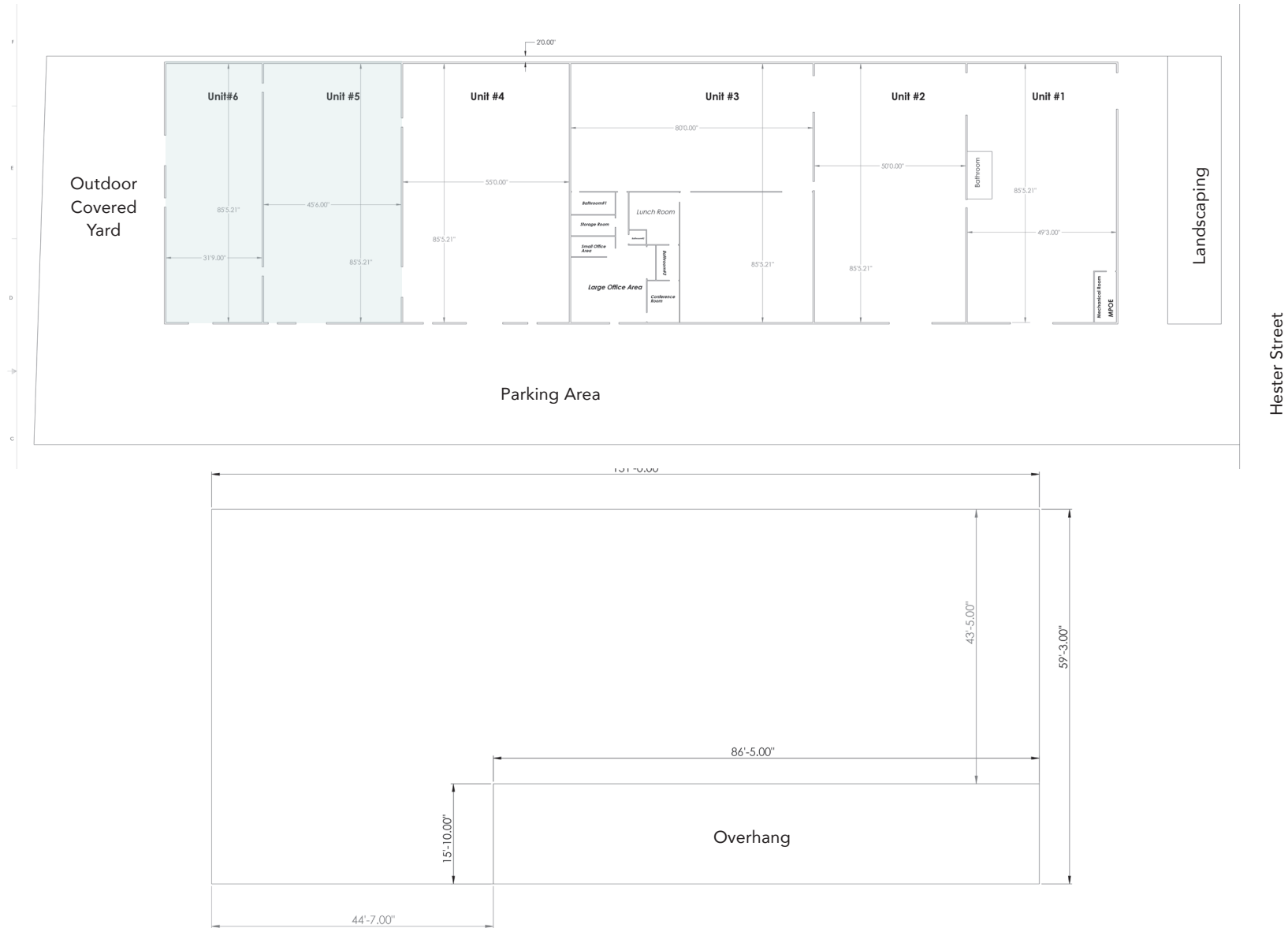

JOIN LOCAL AND NATIONAL FOOD PRODUCERS, WAREHOUSES, AND INDUSTRIAL COMPANIES

- Ghirardelli Chocolate
- Drake's Brewing Company
- 21st Amendment Brewery
- Coca-Cola Bottling
- Pavel's Yogurt
- Georgia-Pacific Corp Manufacturing
- Will's Fresh Foods
- Mi Rancho
- Aryzta Int'l Food
- Galant Food Company
- Spar Sausage Company
- Columbia Cosmetics Manufacturing Inc
- Best Marble & Granite
- Bearing Engineering
- San Francisco Hat Company
- Dispenser Beverages Inc
- Dependable Furniture Manufacturing
- Mr. Plastics
- Costco Wholesale
- TAP Plastics
- Marathon Packing Corp

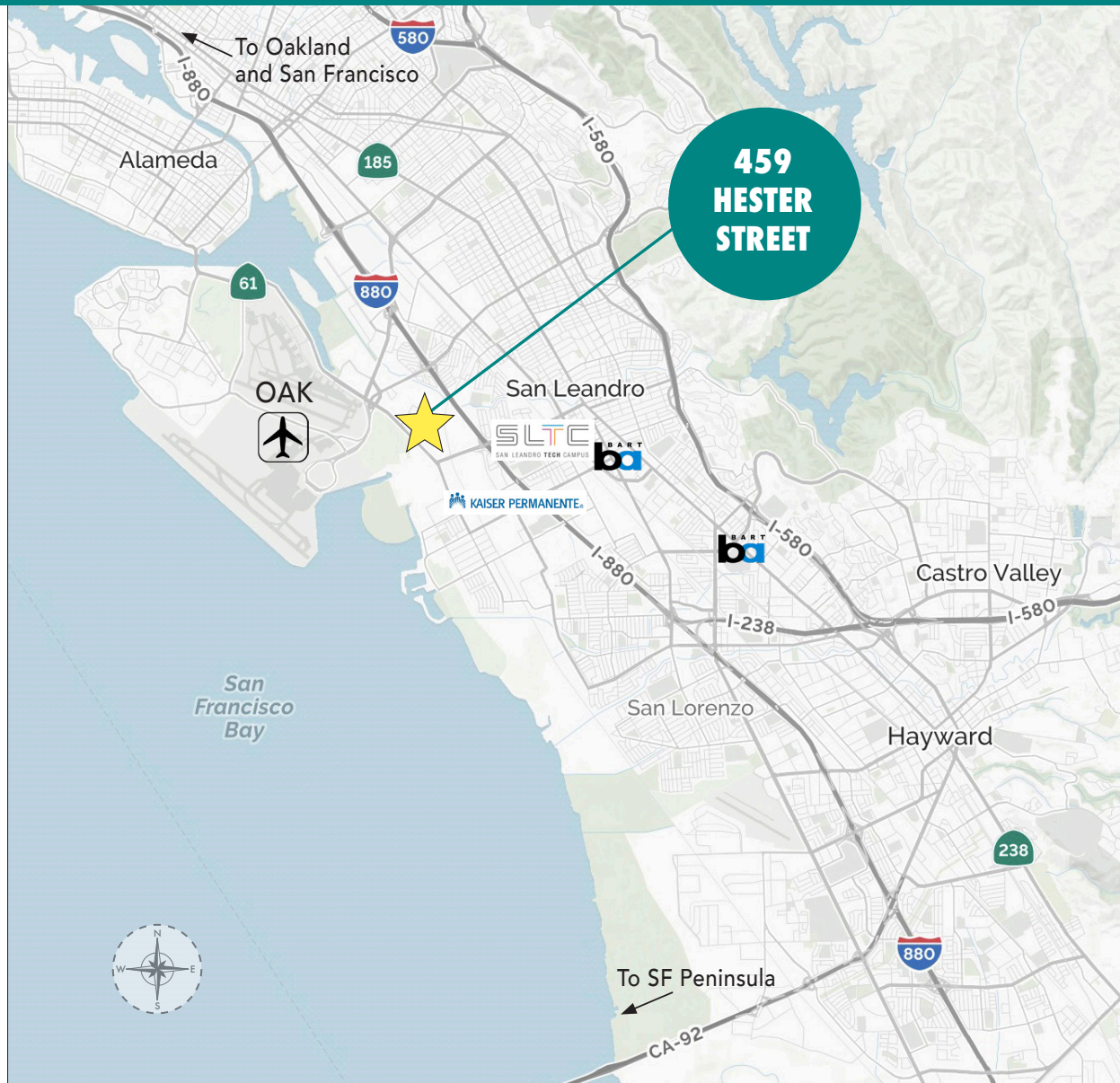

The information contained herein has been provided by the owner of the property or other sources we deem reliable. We have no reason to doubt its accuracy, but we cannot guarantee it. All information should be verified prior to leasing.